

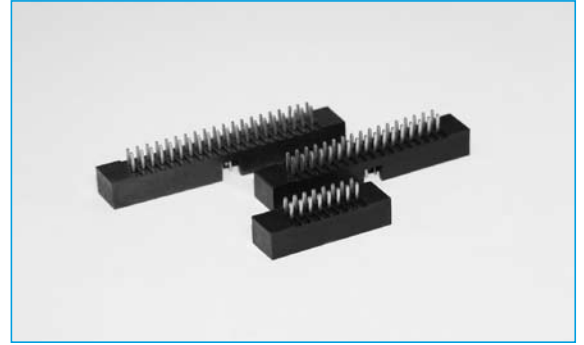

IDC

BOX HEADER STRAIGHT 1.27mm

- Industry compatible
- Competitively priced
- Various Plating contacts available
- 1.27 mm pitch



SPECIFICATION

Material & Finish

- Contact Material:** Phosphor Bronze
- Insulator Material:** Nylon 6T, Glass Reinforced, rated UL 94V-0
- Current Rating:** 1 Amp
- Contact Resistance:** 30M Ω Max.
- Insulator Resistance:** 1000M Ω Min.
- Dielectric Withstanding**
- Voltage:** 250V AC for One Minute
- Operating Temperature:** -40°C to + 105°C

Position	A	B	C
10	12.51	10.84	5.08
12	13.78	12.12	6.35
14	15.05	13.39	7.62
16	16.32	14.66	8.89
20	18.86	17.20	11.43
22	20.13	18.47	12.70
26	22.67	21.01	15.24
30	25.21	23.55	17.78
34	27.25	26.09	20.32
40	31.56	29.90	24.13
44	34.10	32.44	26.67
50	37.91	36.25	30.48

OUTLINE DRAWING

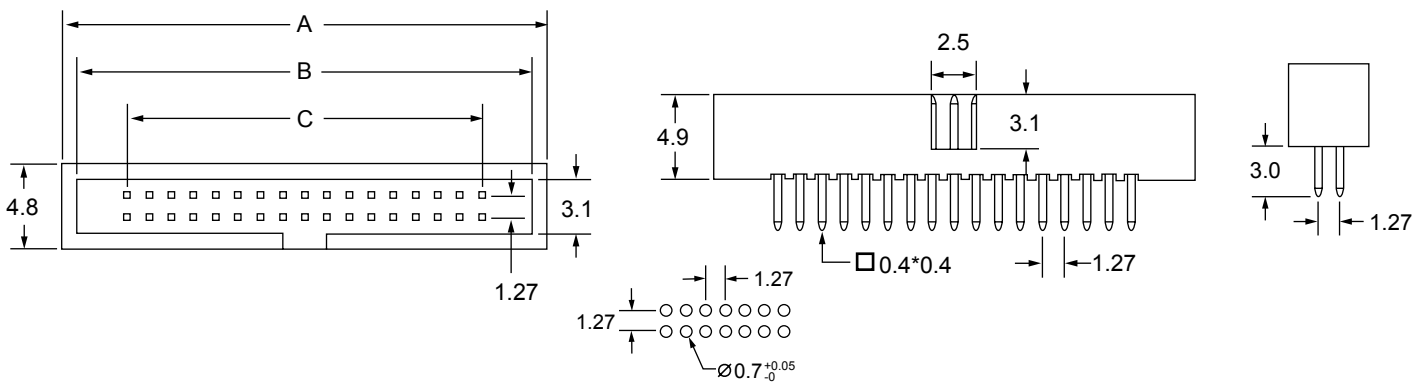

SECTION 15

RECOMMENDED P.C.B. LAYOUT

ORDERING INFORMATION

DBC	IDC	C42	26	B	G	1
Dubilier Connectors	IDC Connector	Series	N° of Ways	Contact Material	Contact Plating	Colour
			10=10way 12=12way 14=14way 16=16way 20=20way 22=22way	B=Phosphor Bronze	G= Gold Flash S=Selective *=Other Plating available	1=Black